



MiniPro Enclosure User Manual

For more information, visit our website at www.oyendigital.com

(1) Specifications

Interface/Ports *	<ul style="list-style-type: none"> • eSATA • FireWire 800 • USB 3.0 Super Speed • USB 2.0 High Speed
Data Transfer *	<ul style="list-style-type: none"> • eSATA up to 3.0Gbps (300MB/s) • FireWire 800 up to 800Mbps (100MB/s) • USB 3.0 up to 4.8Gbps (572MB/s) • USB 2.0 up to 480Mbps (60MB/s)
System Requirements (PC)	<ul style="list-style-type: none"> • eSATA: Windows XP/Vista/7 • FireWire 800: Windows XP/Vista/7 • USB 3.0: Windows XP/Vista/7 • USB 2.0: Windows XP/Vista/7
System Requirements (Mac)	<ul style="list-style-type: none"> • eSATA or USB 3.0: Mac OS 10.4 or higher • FireWire 800: Mac OS 10.2 or higher • FireWire 400: Mac OS 9.2 or higher • USB 2.0: Mac OS 10.2 or higher
Operating Environment	<ul style="list-style-type: none"> • Temperature: 5°C ~ 40°C • Humidity: 10%RH ~ 80%RH
Storage Environment	<ul style="list-style-type: none"> • Temperature: -20°C ~ 70°C • Humidity: 5%RH ~ 90%RH
Power	Input: AC 100-240V, 50-60Hz; or bus power Output: DC +5V/2A
Enclosure Size	4.9 x 3.1 x .9 inches

* Available interfaces and data transfer speeds depend on the model.

(2) Detailed View

LED indicator behind the front panel:
OFF = Power OFF
Solid Blue = Power ON, status ready
Flashing Blue = Power ON, read/write access

MiniPro FW800 / USB 3.0

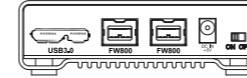

MiniPro eSATA / USB 2.0

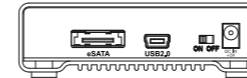

MiniPro USB 3.0

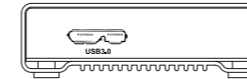

(3) Hard Drive Assembly

a) Remove the screws located at the bottom of the case and pull out the circuit board from the enclosure.

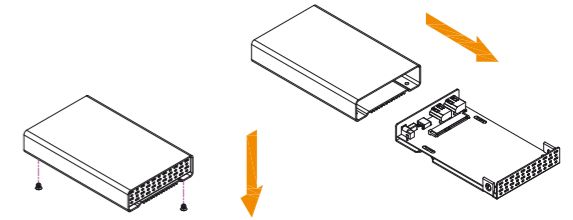

b) Install the hard drive and mount it with the 2 screws from the bottom through the circuit board and with the 2 screws from the side.

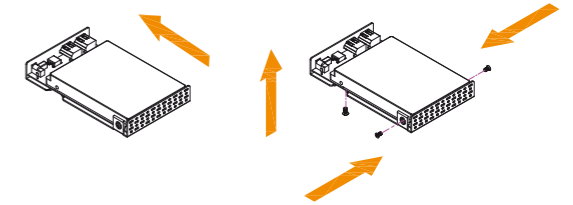

(4) Enclosure Assembly

a) Slide the assembled drive back into the enclosure but be careful not to damage any of the components.

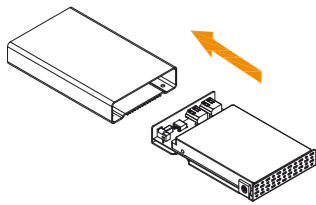

b) Fasten the 4 screws at the bottom of the casing to finish the assembly. Next, peel off the paper from the back of the self-adhesive rubber feet. Now, place the rubber feet over the screws and stick them on the casing to cover the screws.

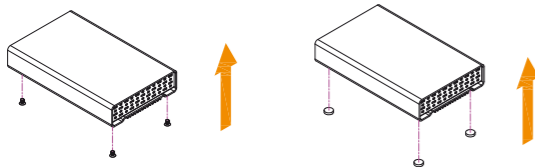

(5) System Set Up

If you have installed the drive yourself and this is a brand new HDD, you will have to create a partition first and format the drive before it is recognized by the computer.

- Turn on your computer
- Connect the MiniPro and turn on the power.
- Use Disk Management on the PC or Disk Utility on the Mac to format the drive.

Windows: <http://oyendigital.com/FAQs.html#11>
Mac: <http://oyendigital.com/FAQs.html#9>

- For the safe removal of your drive and to assure that no data is lost, always eject the external drive from your system first, before you turn it off.

(6) Safety Information

Location and placing precautions

Do not cover the MiniPro and do not place the unit on other heat-sensitive equipment. Avoid positioning it in the following places:

- Locations with direct sunlight, next to radiators or other sources of heat with high temperatures (more than 120° F) or high humidity (more than 90%).
- Locations subject to vibration or shock.
- Do not expose the product to water or humid conditions.

Electricity and power adapter

Careful attention must be paid to the following points in order to avoid operational faults:

- When removing the power cable from the socket, always pull on the plug fixture and never on the cord.

(7) FAQ

Q: What file system should I use to format the drive?

A: This will depend on how you want to use the drive but in general, we recommend:

- Windows 2000/XP/Vista/7 --> NTFS
- Mac OS X --> HFS+ (Mac OS Extended)
- For use with both PC and Mac --> FAT32

Q: Can I use my device with bus power only?

A: This will depend on the model, the hard drive, the interface, and the host computer. Bus power is supported with Firewire and USB in most situations.

Q: Can I use more than one interface at the same time?

A: No, only one interface can be used at any given time. Disconnect the previous cable before connecting the new one.